

ProjectReady[®] and Autodesk BIM 360

Build your project with ProjectReady and connect the power of Autodesk BIM 360 to SharePoint and Box

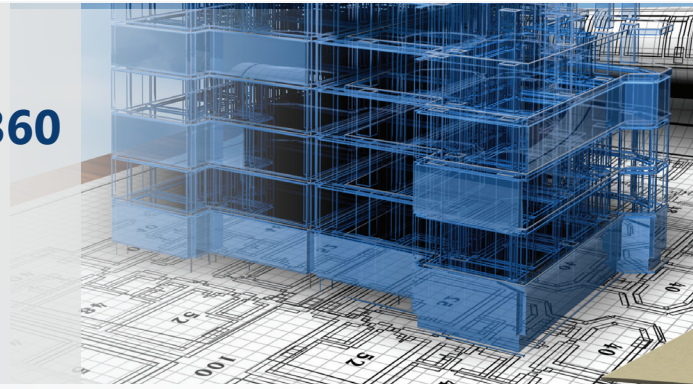

Connect Autodesk with ProjectReady:

Automatically provision Autodesk BIM 360 Projects and connect to SharePoint and Box

- Use the same Project ID to connect BIM 360 to everything else in the project
- Automatically create the correct folders and structure as part of the provisioning process
- Assign BIM Managers

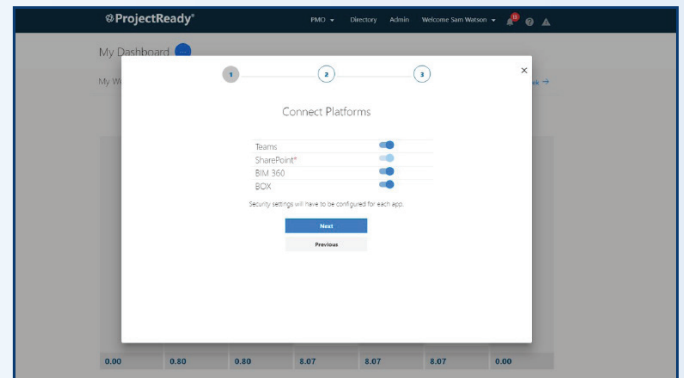

Preview your documents & drawings directly from ProjectReady before adding to your document control package

- Explode model
- Access BIM properties
- Scale & Measure

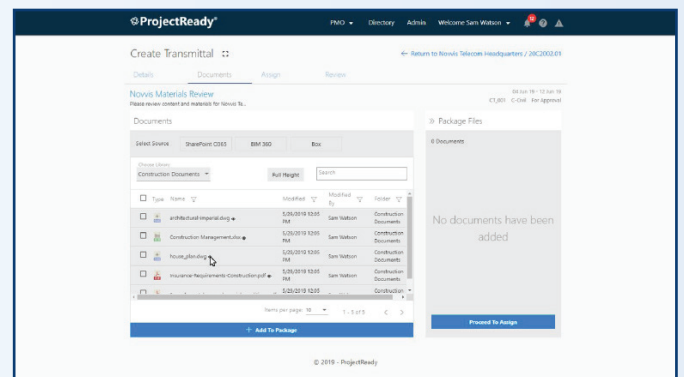

Document Control with seamless integration with SharePoint and Box

- RFI's
- Submit Content for Approval
- Register Project Content
- Change Orders
- Automated Coversheets with content from BIM 360, SharePoint and Box

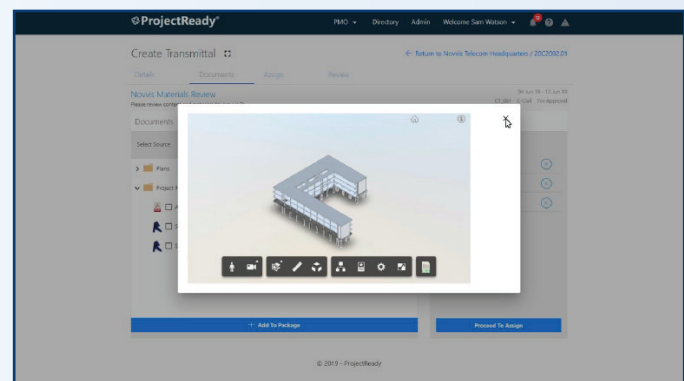

Simplify, Unify & Collaborate Across Your Projects with ProjectReady

 For a demonstration and more information contact us at:
info@project-ready.com - www.Project-Ready.com - 914.751.8088